

1400 HANSELMAN RD.

ANGOLA, IN 46703

260-665-7961

sales@dispatchproducts.com

m

www.dispatchproducts.com

WORKSTATIONS

MULTI-FUNCTION SINGLE POSITIONS

Multi-functional dispatch systems tend to support more than one department. They may dispatch for Police, Fire, EMS as well as Highway and Public Works departments .

Each department may have separate communications systems, computer systems and telephone requirements resulting in many pieces of equipment that need to be accommodated usually in a small space.

Increased utilization of space can be accomplished by the use of multi-level workstations. Acoustic wall panels are available 85" high and shelving can be designed to meet the weight and size of computer monitors, printers, fax machines, telephones and other common equipment.

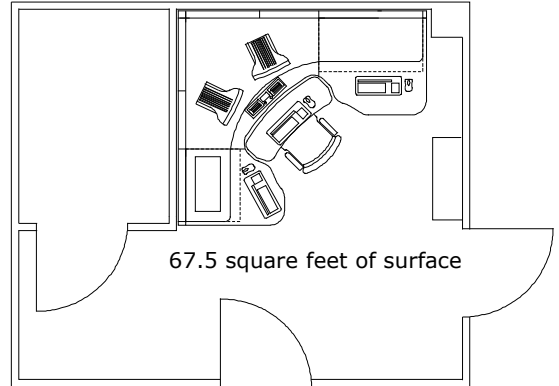

Description

The 3" stackable, segmented wall panels are configured from open frames equipped with bottom raceways. Wall segments of different sizes and material are clipped to the frame to make up the complete wall panel. The segments are easily removable for access to the center of the panels or to the wall.

Panel segment types include fabric over steel, tackable acoustic, bronze, frosted, fluted and clear glazed, perforated steel, open pass through, laminate and wood.

Writing surfaces are fabricated from 45-lb. density 1-1/8" thick core material, pressure bonded with a high-pressure laminate top and sealing backing. The front edge of the writing surfaces is covered with a field replaceable, high impact vinyl bumper molding.

The sit-to-stand keyboard/mouse platform provides 19" of continuous vertical adjustment as well as 15 degrees positive and 15 degrees negative tilt.

CPU cabinets are open to the wall for access to AC and signal cables.

